

G.N. 4093

IMPORT AND EXPORT ORDINANCE (Chapter 60)
(Section 13I(1))

Pursuant to section 13I(1) of the Import and Export Ordinance (Chapter 60) and after consultation with the Airport Authority, I hereby designate the areas described below to be specified areas for the purposes of section 13E(2)(d) of the said Ordinance:—

- (a) The area in West Quay, Hong Kong International Airport, coloured green in Plan No. 1 attached to this Notice.
- (b) The area on 1/F, Super Terminal 1, Hong Kong International Airport, coloured green in Plan No. 2 attached to this Notice.
- (c) The area on 2/F, Terminal 2, Asia Airfreight Terminal, Hong Kong International Airport, coloured green in Plan No. 3 attached to this Notice.
- (d) The area on 5/F, Cathay Pacific Cargo Terminal, Hong Kong International Airport, coloured green in Plan No. 4 attached to this Notice.
- (e) The area on 1/F, Express Centre, Super Terminal 1, Hong Kong International Airport, coloured green in Plan No. 5 attached to this Notice.
- (f) The areas on G/F, Asia Airfreight Terminal, Hong Kong International Airport, coloured green in Plan No. 6 attached to this Notice.

7 July 2023

Ida NG Assistant Commissioner of Customs and Excise (Boundary and Ports)

《進出口條例》(第60章)第13(1)條指明範圍
Section 13(1) of Import and Export Ordinance (Chapter 60) specified area

香港國際機場西岸碼頭
West Quay, Hong Kong International Airport

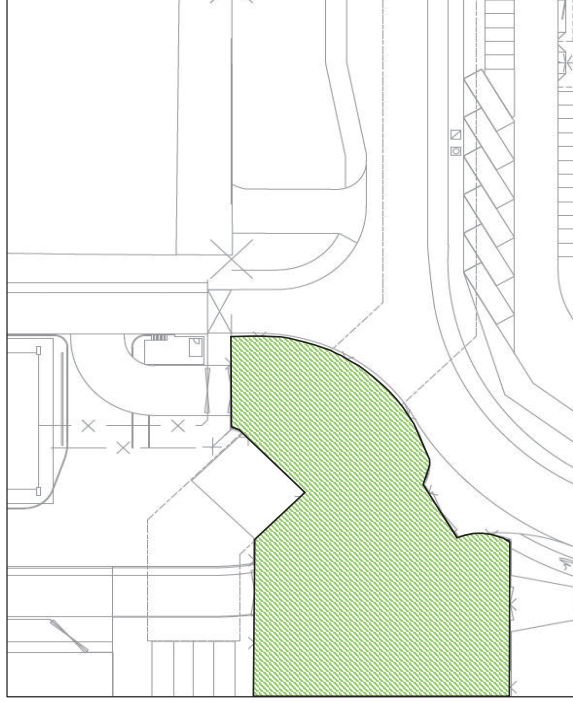
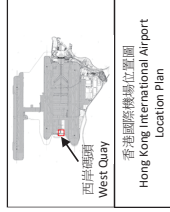

圖例
Legend:

指明範圍
specified area

再根據《進出口條例》(第60章)第13(1)條，本人指定本圖綠色所示的地區為指明範圍。

Pursuant to section 13(1) of the Import and Export Ordinance (Chapter 60), I hereby designate the area coloured green in this plan as specified area.

2023年7月7日
7 July 2023

海關助理關長(邊境及港口) 吳潔貞
Ida NG Assistant Commissioner of Customs and Excise (Boundary and Ports)

《進出口條例》(第60章)第13(1)條指明範圍
Section 13(1) of Import and Export Ordinance (Chapter 60) specified area

香港國際機場超級一號貨站一樓
1/F, Super Terminal 1, Hong Kong International Airport

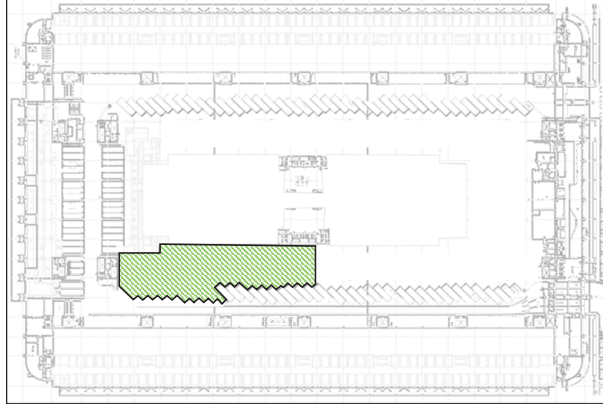
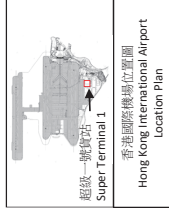

圖例
Legend:
指明範圍
specified area

再根據《進出口條例》(第60章)第13(1)條，本人指定本圖綠色所示的地區為指明範圍。

Pursuant to section 13(1) of the Import and Export Ordinance (Chapter 60), I hereby designate the area coloured green in this plan as specified area.

2023年7月7日
7 July 2023

海關助理關長(邊境及港口) 吳潔貞
Ida NG Assistant Commissioner of Customs and Excise (Boundary and Ports)

《進出口條例》(第60章)第13(1)條指明範圍
Section 13(1) of Import and Export Ordinance (Chapter 60) specified area

香港國際機場亞洲空運中心二號貨站二樓
2/F, Terminal 2, Asia Airfreight Terminal, Hong Kong International Airport

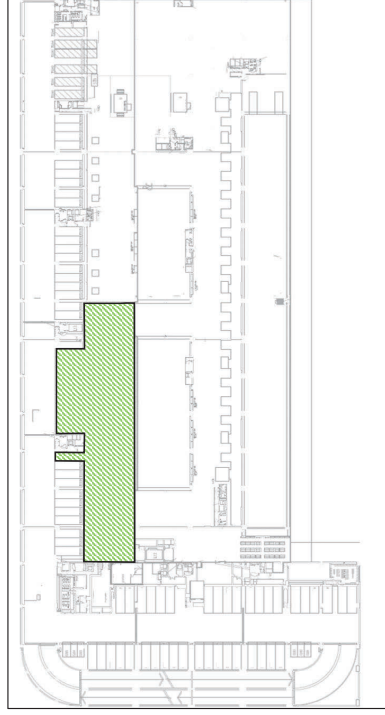
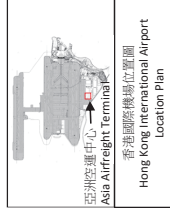

圖例
Legend

指明範圍
specified area

再根據《進出口條例》(第60章)第13(1)條，本人指定本圖綠色所示的地區為指明範圍。

Pursuant to section 13(1) of the Import and Export Ordinance (Chapter 60), I hereby designate the area coloured green in this plan as specified area.

2023年7月7日
7 July 2023

海關助理關長(邊境及港口)吳潔貞
Ida NG Assistant Commissioner of Customs and Excise (Boundary and Ports)

《進出口條例》(第60章)第13(1)條指明範圍
Section 13(1) of Import and Export Ordinance (Chapter 60) specified area

香港國際機場國泰航空貨運站五樓
5/F, Cathay Pacific Terminal, Hong Kong International Airport

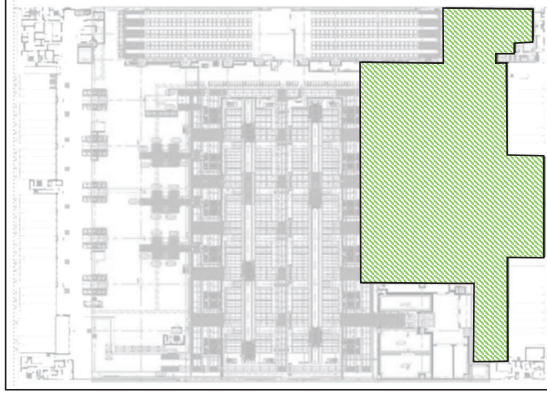
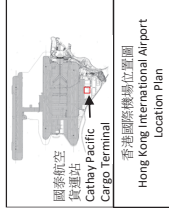

再根據《進出口條例》(第60章)第13(1)條，本人指定本圖綠色所示的地區為指明範圍。

Pursuant to section 13(1) of the Import and Export Ordinance (Chapter 60), I hereby designate the area coloured green in this plan as specified area.

2023年7月7日
7 July 2023

海關助理關長(邊境及港口) 吳潔貞
Ida NG Assistant Commissioner of Customs and Excise (Boundary and Ports)

《進出口條例》(第60章)第13(1)條指明範圍
Section 13(1) of Import and Export Ordinance (Chapter 60) specified area

香港國際機場超級一號貨站速遞中心一樓
1/F, Express Centre, Super Terminal 1, Hong Kong International Airport

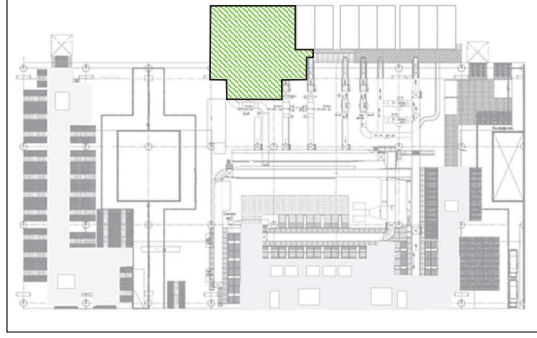
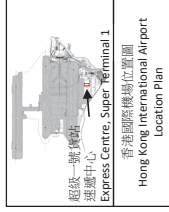

圖例
Legend:
指明範圍
specified area

再根據《進出口條例》(第60章)第13(1)條，本人指定本圖綠色所示的地區為指明範圍。

Pursuant to section 13(1) of the Import and Export Ordinance (Chapter 60), I hereby designate the area coloured green in this plan as specified area.

2023年7月7日
7 July 2023

海關助理關長(邊境及港口)吳潔貞
Ida NG Assistant Commissioner of Customs and Excise (Boundary and Ports)

《進出口條例》(第60章) 第13(1) 條指明範圍
Section 13(1) of Import and Export Ordinance (Chapter 60) specified area

香港國際機場亞洲空運中心地下
G/F, Asia Airfreight Terminal, Hong Kong International Airport

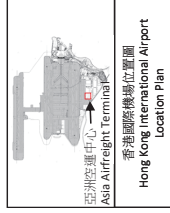

圖例
Legend

指明範圍
specified area

再根據《進出口條例》(第60章) 第13(1) 條，本人指定本圖綠色所示的地區為指明範圍。
Pursuant to section 13(1) of the Import and Export Ordinance (Chapter 60), I hereby designate the areas coloured green in this plan as specified area.

2023年7月7日
7 July 2023

海關助理關長 (邊境及港口) 吳潔貞
Ida NG Assistant Commissioner of Customs and Excise (Boundary and Ports)